

**Układ otworów**

Widok na boku korpusu

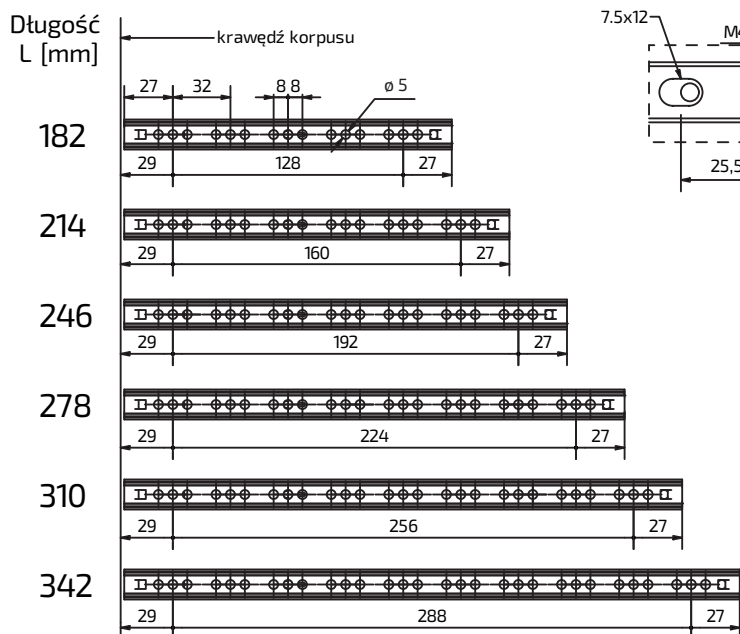

Widok na boku szuflady

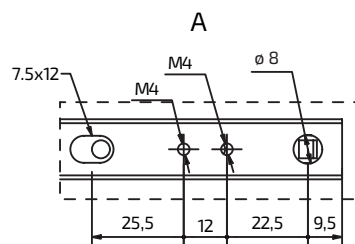
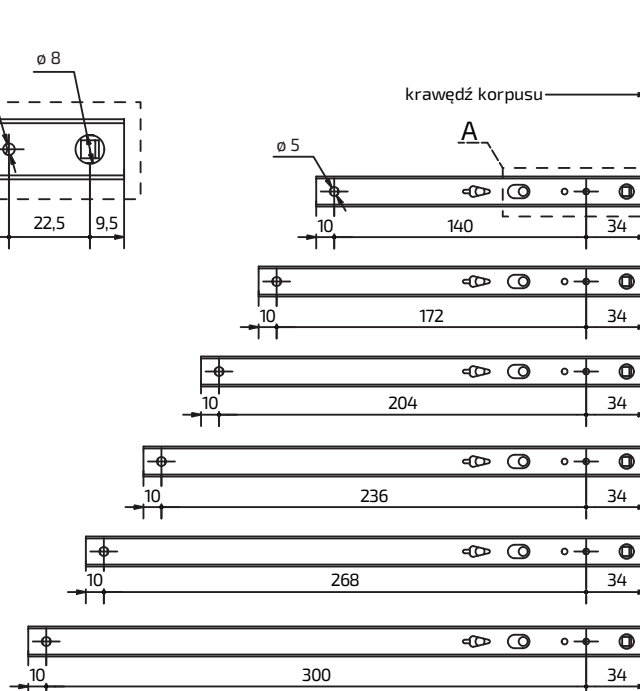

**Wysuw**

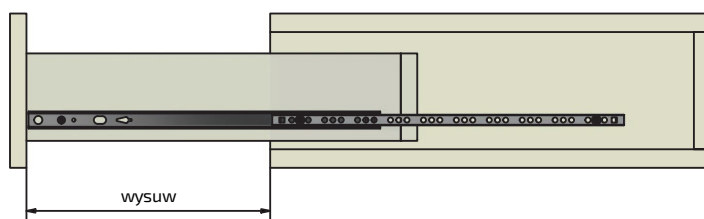
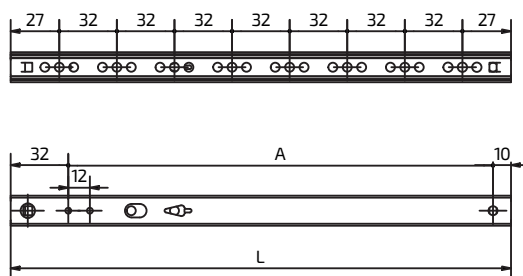

model	L [mm]	wysuw [mm]	A
DB/17-182	182	125	140
DB/17-214	214	134	172
DB/17-246	246	170	204
DB/17-278	278	202	236
DB/17-310	310	208	268
DB/17-342	342	237	300



#### Wymiary montażowe

Widok szuflady od frontu

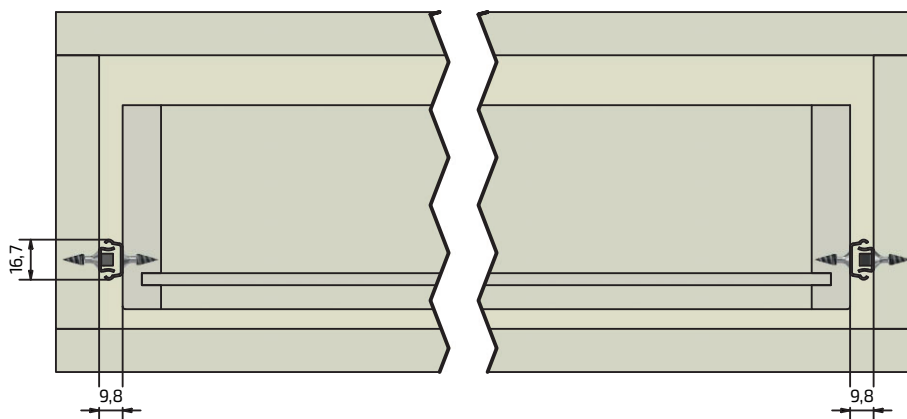

Montaż prowadnic do szuflady i korpusu

